

# Sline 804 F31T

**Facade:**

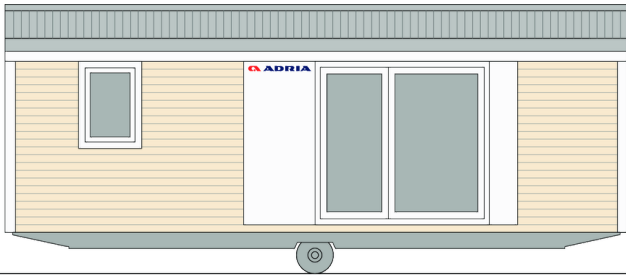

SLine 804 F31T

**Facade 2:**

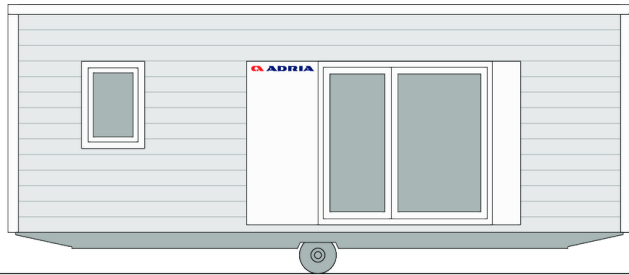

SLine 804 F31T

**Layout:**

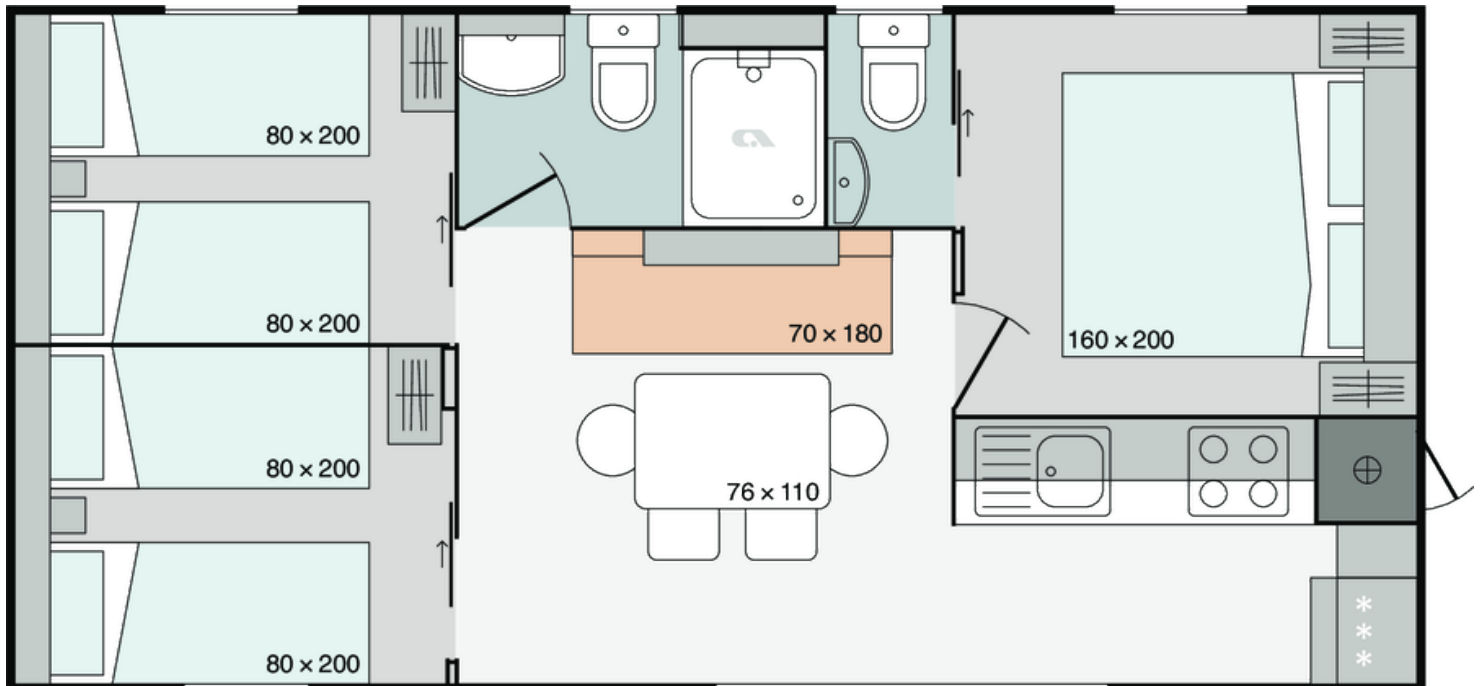

**SLine 804 F31T**

**A1 GENERAL**

Area	32,00
Number of beds	6+1
Number of bedrooms	2
Number of bathrooms	1+WC
Height	3,30
Length	8,00
Width	4,00

**B1 CHASSIS**

100% Galvanized Steel Chassis with leveling feet	X
Inflatable wheels	X
Detachble hook	X
Leveling Feet 1-2%	X

**B2 FLOOR**

Vynil flooring	X
Adria Sandwich Technology ® Floor 40 mm (R=1,01 m2K/W)	O
Moisture resistant CTB-H floor 19 mm with ALU isolation floor foil	X

**B3 EXTERIOR WALLS**

Piva Sandwich Technology ®PST: White woodgrain	O
Piva Sandwich Technology ®PST: Cream sandgrain	X
Other Three Sides: Facade WHITE Jub Peace 45	O
Other Three Sides: Facade VANILLA Jub Family 325	O
Other Three Sides: Facade GREEN Jub Vitality 115	O
Other Three Sides: Facade BROWN GREY Jub Family 15	O
Other Three Sides: Facade BLUE Jub Vitality 20	O
Front Cladding: Larchwood vertical	O
Front Cladding: Larchwood horizontal	O
Front Cladding: Facade VANILLA Jub Family 325	O
Front Cladding: Facade GREEN Jub Vitality 115	O
Front Cladding: Facade BROWN GREY Jub Family 15	O
Front Cladding: Facade BLUE Jub Vitality 20	O
Front Cladding: Soft PVC Vnyl Silver Cedar vertical	O

Front Cladding: Hard PVC White Wood ISO20 horizontal	O
Front Cladding: Hard PVC Grey Wood ISO20 horizontal	O
Decorative Cladding: White Panel	X
Other Three Sides: Soft PVC Vnyl Silver Cedar vertical	O
Other Three Sides: Classic PVC White FS-201 horizontal	O
Other Three Sides: Classic PVC Claystone FS-201 horizontal	O
Other Three Sides: Classic PVC Anthracite FS-201 horizontal	O
Other Three Sides: Classic PVC Silver Grey FS-201 horizontal	O
Other Three Sides: Classic PVC Light Grey FS-201 horizontal	O
Other Three Sides: Hard PVC White wood ISO20 horizontal	O
Other Three Sides: Hard PVC Grey Wood ISO20 horizontal	O
Other Three Sides: Larchwood Horizontal	O
Other Three Sides: Larchwood Vertical	O
Corners: White	X
Corners: Color of cladding	O

#### **B4 WINDOWS AND DOORS**

PVC white windows and doors with termopan glass (U=3 W/m2K)	X
Tinted windows in bathrooms	X
Swing entrance door with security glass and door holder	X
Mosquito nets on all windows - white	O
Built-in blinds on all windows - matching colour of windows and doors	O
Master cylinder	O
Master key (3 pieces)	O
ALU door of external box - matching colour of windows and doors	X

#### **B5 ROOF AND CEILING**

Single-pitched Roof	X
Roof construction class A (150 kg/m2)	X
Roof construction class B (250 kg/m2)	O
Roof type: Galvanized steel roof	X
Roof colour: White	O
Roof Colour: Anthracite	X
Roof Colour: Red	O

Secondary roof type: PVC foil	X
Roof insulation glass wool 50 mm (R=1,25 m2K/W)	X
Roof insulation glass wool 100 mm (R=2,55 m2K/W)	O
Cathedral ceiling in living room and flat roof in other rooms	X
Gutters	X
Vertical draining pipes - matching colour of windows and doors	O

### C0 INTERIOR

Furnishing Decor - STANDARD	STYLE 2022
Textile Combination - STANDARD	PEARL 2022
Textile Combination - OPTION 1	OCEAN 2022
Dimout curtains in all rooms except bathroom and toilet	X
Daily curtains in all rooms except bathroom and toilet	O
Interior separation walls 16 mm	X
Interior doors 25 mm with PVC doorframes	X
Door stopper	X
Metal doorhooks	X

### C1 LIVING ROOM

Sofa extendable	O
Sofa	X
Foldable table	X
Chairs	X
Wall shelf over the sofa in living room	X
Wall decorative cladding	X
Decorative wall in living room	X
Hangers in living room (2 pcs)	X
Mirror in living room	O
Fire extinguisher (1kg) in living room	O
Fire blanket in living room	O
Smoke detector in living room	O
Adria Bluetooth sound system	O

### C2 KITCHEN

Gas hob with 4 burners	X
Glass ceramic hob with 4 burners	O

Induction hob with 4 burners	O
Built-in extractor hood	X
Stainless steel sink with drainer	X
Selfstanding fridge with freezer 217l	X
Built-in dishwasher 450 mm	O
Microwave oven	O
Built-in drainer (scolapiatti)	O
Kitchen backsplash: Glass white wall panel	X
Kitchen backsplash: White wall panel	O
Kitchen backsplash: Decorative laminate	O
LED lightning above kitchen counter	O

### C3 MASTER BEDROOM

Safe in master bedroom	O
Double bed with slatted bed base	160 x 200
Foam mattresses (25 kg/m <sup>2</sup> ) in master bedroom	X
Foam mattresses (35 kg/m <sup>2</sup> ) in master bedroom	O
Topper for mattresses in master bedroom	O
Wooden headboard in master bedroom	X
Bedside tables in master bedroom	X
Wall shelf over the bed in master bedroom	X
Cupboards over the bed in master bedroom	O
Wardrobe in master bedroom	X
Hangers in master bedroom (2 pcs)	O
Mirror in master bedroom	O
TV and aerial socket in master bedroom	O

### C4 CHILDREN BEDROOM

Single beds with slatted bed base	80 x 200
Foam mattresses PN25 in children's bedroom	X
Foam mattresses HR35 in children's bedroom	O
Loft bed in children's bedroom	O
Underbed in children's room	O
Wooden headboard in children's bedroom	X
Bedside tables in children's bedroom	X

Wall shelf over the bed in children's bedroom	X
Cupboards over the bed in children's bedroom	O
Wardrobe in children's bedroom	X
Hangers in children's bedroom (2 pcs)	O
Mirror in children's bedroom	O

### C5 CHILDREN BEDROOM 2

Single beds with slatted bed base	80 x 200
Foam mattresses PN25 in children's bedroom 2	X
Loft bed in children's bedroom 2	O
Underbed in children's room 2	O
Wooden headboard in children's bedroom 2	X
Bedside tables in children's bedroom 2	X
Wall shelf over the bed in children's bedroom 2	X
Cupboards over the bed in children's room 2	O
Wardrobe in children's bedroom 2	X
Hangers in children's room 2 (2 pcs)	O
Mirror in children's bedroom 2	O

### C6 BATHROOM

Shower cabin	80 x 100
Shower PVC wall	X
Shower rail with sliding shower holder	O
Shower folding doors with security glass	X
Wash-stand with mixer tap	X
Mirror with shelf in bathroom	X
Ceramic toilet with toilet seat	X
PVC toilet tank with saving function	X
Bidet with mixer tap in bathroom	O
Towel holder	X
Toilet roll holder	X
Hangers in bathroom (2 pcs)	1X
Hairdryer in bathroom	O

### C8 SEPARATE TOILET

Wash-basin with mixer tap	X
---------------------------	---

Mirror in separate toilet	O
Ceramic toilet with toilet seat	X
Ceramic toilet tank with saving function	O
Ceramic toilet with toilet seat for handicaped person	X
Built-in toilet tank with saving function	O
Towel holder	O
Toilet roll holder	X

### D1 WATER AND GAS

External connector to water facilities with pressure regulator	X
Connection to central warmwater system	O
Additional connection to central wastewater system for toilet tank	O
Water filter in technical box	O
PVC water pipes Speedfit®	X
Central waste water outlet	O
External access to water heater	X
Gas water heater Vaillant 11l natural push	X
Electrical water heater 80l	O
Gas connection in box: Propan/Butan 30 mBar	X
External gas connection: Methan	O
Insulated water pipes with electrical heating	O

### D2 ELECTRICITY

White surface mounted installations, sockets and switches	X
External connection 32A, 250V, 2P+E	X
External connection 32A, 400V, 3P+N+E	O
Built-in ceiling spot LED lights in all rooms	X
Reading LED lights in all rooms	X
Key lock	O
TV socket	X
USB socket	O
UTP socket	O

### D3 MULTIMEDIA

TV holder	O
LED TV 32 inch	O



TV holder with double fold function	O
-------------------------------------	---

**D4 HEATING AND COOLING**

Preinstallation for Airconditioning in living room	X
--	---

Airco sensors for entrance door	O
---------------------------------	---

Airco sensors for all windows except bathrom	O
--	---

Airco Card	O
------------	---

Air-conditioning white - mono split	O
-------------------------------------	---

Electrical heater in living room	O
----------------------------------	---

Electrical heater in master bedroom	O
-------------------------------------	---

Electrical towel heater in bathroom	O
-------------------------------------	---

Electrical underfloor heating system Ebecco ® in all rooms	O
--	---

**E1 EXTERIOR EQUIPMENT**

Awning LED light	X
------------------	---

External socket - matching colour of windows and doors	O
--	---

Terrace	O
---------	---

### Legal Notice

The information on this website is provided "as is" and without warranty of any kind, expressed or implied, including (but not limited to) any implied warranties of merchantability and non-infringement of third party rights. While the information provided is believed to be accurate, it may include errors or inaccuracies. In no event shall Adria Home be liable to any person for any special, indirect or consequential damages relating to this material, unless caused by gross negligence or intentional misconduct. The purpose of this website is illustrative. The website may show visuals which may include some elements not belonging to the standard equipment or portray products which may not be available in all markets. Products may change in terms of technical specification and commercial details and in relation to specific regulations. You are advised to always contact your selected Adria representative to obtain all detailed information prior to purchasing.

### Copyright

Copyright © Adria Home Ltd., ?rnatelj, Slovenia 2019-20. All rights reserved. The text, images, graphics, sound files, animation files, video files, and their arrangement on the Adria Home website are all subject to copyright and other intellectual property protection. These objects may not be copied for commercial use or distribution, nor may these objects be modified or reposted to other sites. Adria Home website may contain images whose copyrights are attributable to third parties.



Adria Home Ltd.  
Kanižarica 41, SI-8340 ?rnatelj, Slovenija, Tel: +386 (0) 7 35 69 100, E-mail: info@adria-home.com  
adria-home.com , www.adria-holidays.net

#AdriaHome  
#AdriaGlamping

