

# Mline 854 B32

**Facade:**



**MLine 854 B32**

**Layout:**

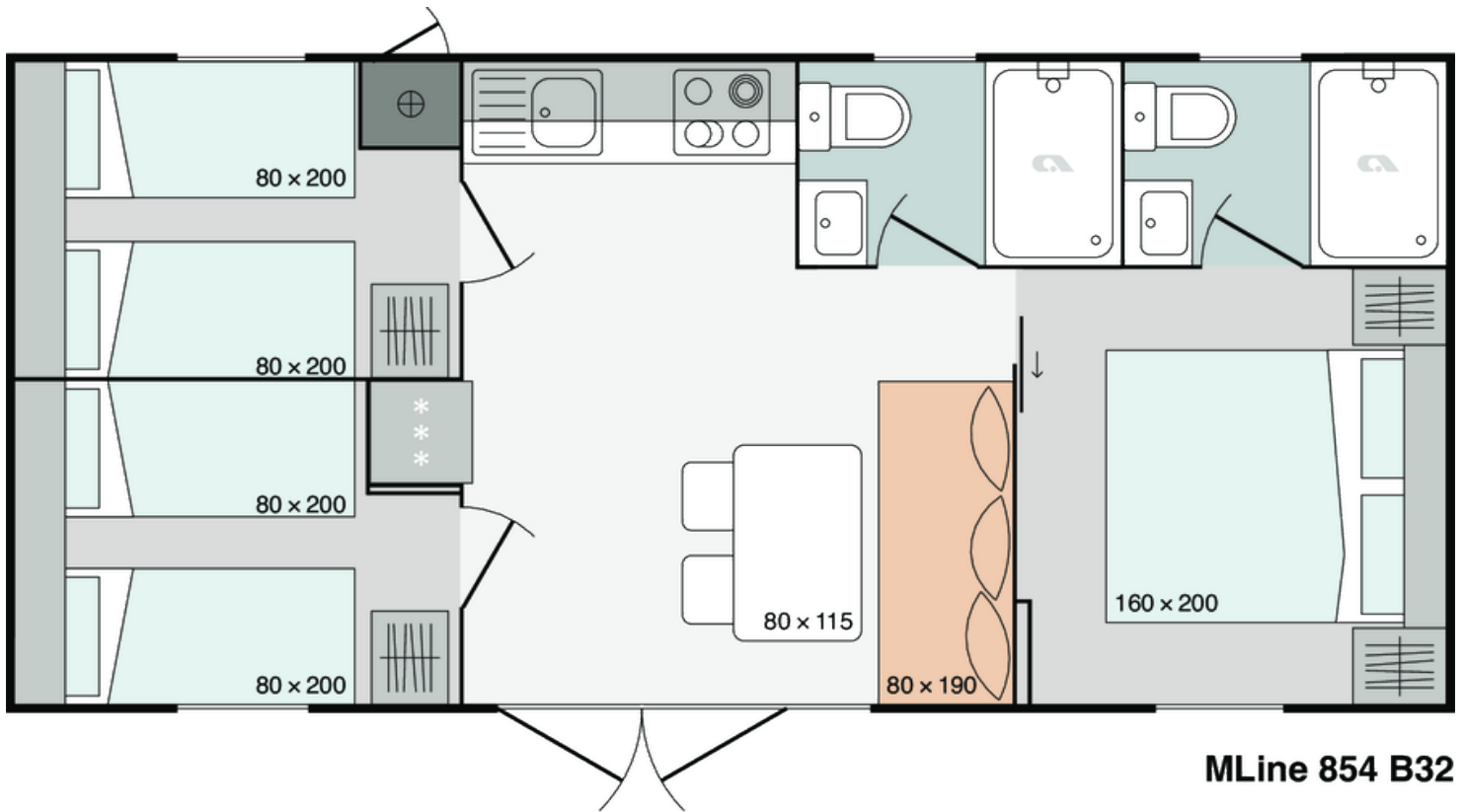

**C6 BATHROOM**

Electrical socket in bathroom		X
Shower cabin	80 x 120	
Shower sliding doors with security glass		X
Shower PVC wall		X
Shower rail with sliding shower holder		X
Shower rail with adjustable sliding shower holder and rain shower head		O
Wash-stand with mixer tap		X
Mirror with shelf in bathroom		X
Ceramic toilet with toilet seat		X
PVC toilet tank with saving function		X
Built-in toilet tank with saving function		O
Built-in toilet tank with saving function connected to wash-stand		O
Towel holder		X
Toilet roll holder		X
Hangers in bathroom (2 pcs)		X
Hairdryer in bathroom		O
Bathroom fan in bathroom		O
Built-in ceiling spot LED lights in bathroom		X
Shower cabin with low profile tray and decorative PVC shower wall		O

**C7 BATHROOM 2**

Electrical socket in bathroom 2		X
Shower cabin	80 x 120	
Shower sliding doors with security glass		X
Shower PVC wall		X
Shower rail with sliding shower holder		X
Shower rail with adjustable sliding shower holder and rain shower head		O
Wash-stand with mixer tap		X
Mirror with shelf in bathroom 2		X
Ceramic toilet with toilet seat		X
PVC toilet tank with saving function		X
Built-in toilet tank with saving function		O

Built-in toilet tank with saving function connected to wash-stand	O
Towel holder	X
Toilet roll holder	X
Hangers in bathroom 2 (2 pcs)	X
Hairdryer in bathroom 2	O
Bathroom fan in bathroom 2	O
Built-in ceiling spot LED lights in bathroom 2	X

## C2 KITCHEN

Electrical sockets over the kitchen counter (2x)	X
Built-in ceiling spot LED lights in kitchen	X
Gas hob on glass ceramic platform 4 burners	X
Glass ceramic hob with 4 burners	O
Induction hob with 4 burners	O
Shelving in kitchen	O
Built-in extractor hood	X
Stainless steel sink with drainer	X
Granite sink with drainer	O
Built-in bin separator 16L	O
Selfstanding fridge with freezer 217l	X
Built-in fridge with freezer 270 l	O
Built-in dishwasher 450 mm	O
Microwave oven	O
Built-in microwave oven	O
Built-in drainer (scolapiatti)	O
Kitchen backsplash: Glass white wall panel	X
Kitchen backsplash: White wall panel	O
Kitchen backsplash: Decorative laminate	X
Wooden wall panel with shelve over fridge	X
LED lightning above kitchen counter	O

## A1 GENERAL

Area	34,00
Number of beds	6+1
Number of bedrooms	3

Number of bathrooms	2
Length	8,50
Width	4,00
Height	3,45

### B1 CHASSIS

100% Galvanized Steel Chassis	X
Inflatable wheels	X
Detachble hook	X
Leveling Feet	X

### B2 FLOOR

Vynil flooring	X
Moisture resistant CTB-H floor 19 mm with ALU isolation floor foil	X

### B3 EXTERIOR WALLS

Adria Sanwdich Technology @AST external walls 45 mm (R=1,35 m <sup>2</sup> K/W)	X
Decorative attic: Metal sheet - matching colour of windows and doors	X
Cladding L/R: Facade without final layer	X
Cladding L/R: Facade VANILLA Jub Family 325	O
Cladding L/R: Facade GREEN Jub Vitality 115	O
Cladding L/R: Facade BLUE Jub Vitality 20	O
Cladding L/R: Facade BROWN GREY Jub Family 15	O
Cladding L/R: White Metal Panel	O
Cladding L/R: Anthracite Metal Panel	O
Cladding L/R: Adria PVC Whiteline horizontal	O
Cladding L/R: Adria PVC Blackline horizontal	O
Cladding L/R: Larchwood horizontal	O
Cladding L/R: Larchwood vertical	O
Cladding L/R: Larchwood Blackline horizontal	O
Cladding L/R: Trend PVC Ivory SOFT FS-301 vertical	O
Cladding L/R: Trend PVC Mastic SOFT FS-301 vertical	O
Cladding L/R: Trend PVC Anthracite SOFT FS-301 vertical	O
Cladding L/R: Trend PVC Pearl Grey STONE FS-301 vertical	O

Decorative Cladding: Facade without final layer	X
Decorative Cladding: Facade VANILLA Jub Family 325	O
Decorative Cladding: Facade GREEN Jub Vitality 115	O
Decorative Cladding: Facade BLUE Jub Vitality 20	O
Decorative Cladding: Facade BROWN GREY Jub Family 15	O
Decorative Cladding: White Panel	O
Decorative Cladding: Anthracite panel	O
Decorative Cladding: Larchwood vertical	O
Decorative Cladding: Larchwood Blackline horizontal	O
Decorative Cladding: Adria PVC Whiteline horizontal	O
Decorative Cladding: Trend PVC Ivory SOFT FS-301 vertical	O
Decorative Cladding: Trend PVC Mastic SOFT FS-301 vertical	O
Decorative Cladding: Trend PVC Anthracite SOFT FS-301 vertical	O
Decorative Cladding: Trend PVC Pearl Grey STONE FS-301 vertical	O
Other Three Sides: Soft PVC Vnyl Silver Cedar vertical	X
Other Three Sides: Trend PVC Ivory SOFT FS-301 vertical	O
Other Three Sides: Trend PVC Mastic SOFT FS-301 vertical	O
Other Three Sides: Trend PVC Anthracite SOFT FS-301 vertical	O
Other Three Sides: Trend PVC Pearl Grey STONE FS-301 vertical	O
Other Three Sides: Facade VANILLA Jub Family 325	O
Other Three Sides: Facade GREEN Jub Vitality 115	O
Other Three Sides: Facade BLUE Jub Vitality 20	O
Other Three Sides: Facade BROWN GREY Jub Family 15	O
Other Three Sides: Larchwood Vertical	O
Other Three Sides: Larchwood Horizontal	O
Other Three Sides: Larchwood Blackline horizontal	O
Corners: Color of cladding	X
Decorative Cladding: Larchwood horizontal	O
Other Three Sides: Adria PVC Whiteline horizontal	O
Other Three Sides: Adria PVC blackline horizontal	O
Decorative Cladding: Adria PVC Blackline horizontal	O

#### **B4 WINDOWS AND DOORS**

PVC white windows and doors with termopan glass	X
Tinted windows in bathrooms	X

Swing entrance door with security glass and door holder	X
Panoramic sliding entrance door with security glass	O
Built-in blinds on all windows - matching colour of windows and doors	O
Rolo shutters on bathroom windows	O
Master cylinder	O
ALU door of external box - matching colour of windows and doors	X
Master key (3 pieces)	O
Mosquito nets on all windows - matching colour of windows	O

### B5 ROOF AND CEILING

Single-pitched Roof	X
Roof construction class A (150 kg/m <sup>2</sup> )	X
Roof type: Galvanized steel roof	X
Roof colour: White	X
Roof Colour: Anthracite	O
Roof type: PVC roof	O
Secondary roof type: PVC foil	X
Roof insulation glass wool 50 mm (R=1,25 m <sup>2</sup> K/W)	X
Flat higher ceiling in all rooms 225 cm	X
Gutters	X
Vertical draining pipes - matching colour of windows and doors	O
Gutter guard for leaves	O
Roof construction class B (250 kg/m <sup>2</sup> )	O

### C0 INTERIOR

Textile Combination - STANDARD	PARIS 2022
Textile Combination - OPTION 1	MARSEILLES 2022
Textile Combination - OPTION 2	MILANO 2022
Textile Combination - OPTION 3	RIMINI 2022
Furnishing Decor - STANDARD	NATURAL 2022
Dimout curtains in all rooms except bathroom and toilet	X
Daily curtains in all rooms except bathroom and toilet	O
Sofa Cushions - STANDARD	SILVER MAGIC 2022
Sofa Cushions - OPTION 1	FRESH WIND 2022



Sofa Cushions - OPTION 2	DIAMOND SPARKLE 2022
Sofa Cushions - OPTION 3	GOLDEN STAR 2022
Interior separation walls 16 mm	X
Interior doors 25 mm with PVC doorframes	X
Door stopper	X
Metal doorhooks	X
Soft close for furniture	X
Bathroom and toilet door with lock	X

### C1 LIVING ROOM

Sofa	X
Sofa extendable	O
Sofa with decorative seams	O
Sofa with decorative seams extendable	O
Dinning table	X
Chairs	X
Wall shelf over the sofa in living room	X
Hangers in living room (2 pcs)	X
Mirror in living room	X
Fire extinguisher (1kg) in living room	O
Fire blanket in living room	O
Smoke detector in living room	O
Adria Bluetooth sound system	O
Decorative wall in living room	X
Ambiental LED lightning in living room	O
UTP socket in living room	O
Built-in ceiling spot LED lights in living room with 2-way switch	X
TV module in living room (1x TV socket, 2x el. socket)	X
Electrical sockets in living room (2x)	X

### C3 MASTER BEDROOM

Double bed with slatted bed base	160 x 200
Foam mattresses (25 kg/m <sup>2</sup> ) in master bedroom	X
Foam mattresses (35 kg/m <sup>2</sup> ) in master bedroom	O
Wooden bed upholstery in master bedroom	O

Upholstered bed in master bedroom	O
Ottoman upholstered bed in master bedroom	O
Ottoman bed with wooden upholstery in master bedroom	O
Wooden headboard in master bedroom	X
Upholstered headboard in master bedroom	O
Bedside tables in master bedroom	X
Wall shelf over the bed in master bedroom	X
Decorative wall panel above shelf in master bedroom	O
Cupboards over the bed in master bedroom	O
Wardrobe in master bedroom	X
Hangers in master bedroom (2 pcs)	X
Mirror in master bedroom	X
Safe in master bedroom	O
TV module in master bedroom (1x TV socket, 2x socket)	O
Built-in ceiling spot LED lights in master bedroom with 2-way switch	X
Reading LED lights in master bedroom	X
Electrical sockets in master bedroom (2x)	X
Ambiental LED lightning under the shelf in master bedroom	O
USB charging modules in master bedroom (2 x C, 2 x A)	O
UTP socket in master bedroom	O

#### **C4 CHILDREN BEDROOM**

Single beds with slatted bed base	80 x 200
Loft bed in children's bedroom	O
Foam mattresses PN25 in children's bedroom	X
Foam mattresses HR35 in children's bedroom	O
Wooden bed upholstery in children's bedroom	O
Upholstered bed in children's bedroom	O
Underbed in children's room	O
Wooden headboard in children's bedroom	X
Upholstered headboard in children's bedroom	O
Wooden wall panel alongside bed in children's bedroom	O
Upholstered wall panel alongside bed in children's bedroom	O
Bedside tables in children's bedroom	X
Wall shelf over the bed in children's bedroom	X

Decorative wall panel above shelve in children's bedroom	O
Cupboards over the bed in children's bedroom	O
Wardrobe in children's bedroom	X
Hangers in children's bedroom (2 pcs)	O
Mirror in children's bedroom	O
Ambiental LED lightning under the shelf in children's bedroom	O
Reading LED lights in children's bedroom	X
Electrical sockets in children's bedroom (2 pcs)	X
USB charging module in children's bedroom (1x C, 1x A)	O
Built-in ceiling spot LED lights in children's bedroom with 1-way switch	X

## C5 CHILDREN BEDROOM 2

Single beds with slatted bed base	80 x 200
Loft bed in children's bedroom 2	O
Foam mattresses PN25 in children's bedroom 2	X
Foam mattresses HR35 in children's bedroom 2	O
Underbed in children's room 2	O
Wooden headboard in children's bedroom 2	X
Uphosltered headboard in children's bedroom 2	O
Wooden wall panel alongside bed in children's bedroom 2	O
Upholstered wall panel alongside bed in children's bedroom 2	O
Bedside tables in children's bedroom 2	X
Wall shelf over the bed in children's bedroom 2	X
Decorative wall panel above shelve in children's bedroom 2	O
Cupboards over the bed in children's room 2	O
Wardrobe in children's bedroom 2	X
Hangers in children's room 2 (2 pcs)	O
Mirror in children's bedroom 2	O
Built-in ceiling spot LED lights in children's room 2 with 1-way switch	X
Ambiental LED lightning under the shelf in children's bedroom 2	O
Reading LED lights in children's bedroom 2	X
Electrical sockets in children's bedroom 2 (2x)	X
USB charging module in children's bedroom 2 (1x C, 1x A)	O
Wooden bed upholstery in children's bedroom 2	O

Upholstered bed in children's bedroom 2	○
---	---

### D1 WATER AND GAS

External connector to water facilities with pressure regulator	X
--	---

Additional connection to central wastewater system for toilet tank	○
--	---

PVC water pipes Speedfit®	X
---------------------------	---

Central waste water outlet	○
----------------------------	---

Water filter in technical box	○
-------------------------------	---

External access to water heater	X
---------------------------------	---

Gas water heater Vaillant 11l natural push	X
--	---

Gas connection in box: Propan/Butan 30 mBar	X
---	---

External gas connection: Methan	○
---------------------------------	---

Electrical water heater 50l	○
-----------------------------	---

Electrical water heater 80l	○
-----------------------------	---

Electrical water heater 100l	○
------------------------------	---

External gas connection: Propan/Butan 30 mbar	○
---	---

External gas connection: Propan/Butan 50 mbar	○
---	---

### D2 ELECTRICITY

White flush mounted installations, sockets and switches	X
---	---

External connection 32A, 250V, 2P+E	X
-------------------------------------	---

External connection 32A, 400V, 3P+N+E	○
---------------------------------------	---

Key lock	○
----------	---

### E1 EXTERIOR EQUIPMENT

Awning LED light	X
------------------	---

External socket - matching colour of windows and doors	X
--	---

External socket under chassis	○
-------------------------------	---

Terrace	○
---------	---

### D4 HEATING AND COOLING

Preinstallation for Airconditioning in living room	X
--	---

Airco Card	○
------------	---

Airco sensors for entrance door	○
---------------------------------	---

Airco sensors for all windows except bathrom	○
--	---

Air-conditioning white - mono split	○
-------------------------------------	---

Electrical heater in living room	<input type="radio"/>
Electrical heater in master bedroom	<input type="radio"/>
Electrical towel heater in bathroom	<input type="radio"/>
Electrical heater in children's room 2	<input type="radio"/>
Electrical heater in children's room	<input type="radio"/>
Additional control of underfloor heating in the bathroom	<input type="radio"/>

**D3 MULTIMEDIA**

TV holder	<input type="radio"/>
TV holder with double fold function	<input type="radio"/>
LED TV 32 inch	<input type="radio"/>

**E1 OPTION PACKAGES**

Premium package Mline	<input type="radio"/>
-----------------------	-----------------------

**Legal Notice**

The information on this website is provided "as is" and without warranty of any kind, expressed or implied, including (but not limited to) any implied warranties of merchantability and non-infringement of third party rights. While the information provided is believed to be accurate, it may include errors or inaccuracies. In no event shall Adria Home be liable to any person for any special, indirect or consequential damages relating to this material, unless caused by gross negligence or intentional misconduct. The purpose of this website is illustrative. The website may show visuals which may include some elements not belonging to the standard equipment or portray products which may not be available in all markets. Products may change in terms of technical specification and commercial details and in relation to specific regulations. You are advised to always contact your selected Adria representative to obtain all detailed information prior to purchasing.

**Copyright**

Copyright © Adria Home Ltd., ?rnatelj, Slovenia 2019-20. All rights reserved. The text, images, graphics, sound files, animation files, video files, and their arrangement on the Adria Home website are all subject to copyright and other intellectual property protection. These objects may not be copied for commercial use or distribution, nor may these objects be modified or reposted to other sites. Adria Home website may contain images whose copyrights are attributable to third parties.



Adria Home Ltd.

Kanižarica 41, SI-8340 ?rnatelj, Slovenija, Tel: +386 (0) 7 35 69 100, E-mail: info@adria-home.com

adria-home.com , www.adria-holidays.net

#AdriaHome  
#AdriaGlamping